

X-ray

MASTER-USE FOR MAKING COPIES

Outpatient Testing



Imaging test to be performed:

Mammography

Patient's name: _____

Test date: _____

Test time: _____

See other side for test location and registration instructions

What You Need To Know

How to prepare for your test:

Tell us if you have breast implants.

Tell us if you are pregnant or breastfeeding.

Don't wear deodorant or talcum powder prior to your exam.

How long will the test take?

About 30 minutes.

What is the purpose of the test?

To aid in the diagnosis of breast diseases in women. Most medical experts agree that successful treatment of breast cancer often is linked to early diagnosis. A mammogram can show changes in the breast up to 2 years before a patient or physician can feel them.

How is the test performed?

You will be asked to undress from the waist up and will be given a gown to wear. One breast at a time will be rested on a flat surface that contains the x-ray plate. Compression will be applied to help spread the breast tissue to enable it to be better visualized. This compression should be snug, but not painful. The x-ray pictures will be taken from a couple of angles to visualize all of the breast tissue. You may be asked to hold your breath as each picture is taken.

Two radiologists will read your mammogram.

Required before test:

Please provide a signed physician order to perform the exam.

Results will be sent to your ordering physician after a radiologist's review.

Your test will be conducted at:

EIRMC (main campus)
 Medical Imaging Department
 3100 Channing Way
 Idaho Falls
208-227-2600

EIRMC Imaging Center
 1670 John Adams Pkwy
 Idaho Falls
208-535-4555

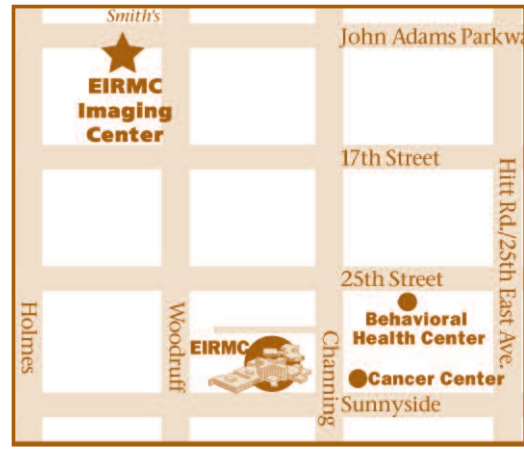
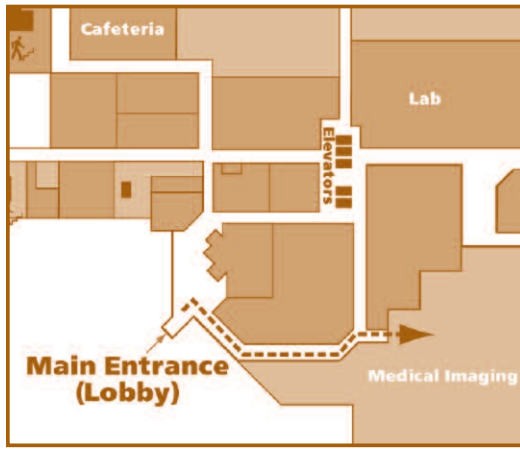

How to register:

Please arrive 10 – 15 minutes early to register (unless you are instructed differently). See the following schedule for guidance on where and when to register. You will need to show a copy of your insurance card and driver's license each time you register.

If your test is at the EIRMC main campus:

Day/Time	Where to Register
<i>Mon.- Fri.</i>	
12 - 6:30 a.m.	Emergency Dept. (as outpatient)
6:30 a.m. - 4:30 p.m.	Medical Imaging Dept.
4:30 - 7 p.m.	Main Admissions (front of hospital)
7 p.m. - midnight	Emergency Dept. (as outpatient)
<i>Saturday</i>	
12 - 7:30 a.m.	Emergency Dept. (as outpatient)
7:30 a.m. - 4 p.m.	Main Admissions (front of hospital)
4 p.m. - midnight	Emergency Dept. (as outpatient)
<i>Sunday</i>	
All day	Emergency Dept. (as outpatient)

If your test is at the EIRMC Imaging Center:

Day/Time	Where to Register
<i>Monday</i>	
8:30 a.m. - 4 p.m.	Imaging Center
<i>Tuesday-Thursday</i>	
8:30 a.m. - 8 p.m. (5-8 p.m., Mammograms only)	Imaging Center
<i>Friday</i>	
8:30 a.m. - 7 p.m. (5-7 p.m., Mammograms only)	Imaging Center
<i>Saturday</i>	
9 a.m. - 4 p.m. (Mammograms only)	Imaging Center